

DURABILITY THAT DELIVERS PROFITABILITY

Eicher LMD Chassis

The 5 to 13 Tonne GVW Chassis



EUTECH 6

EUTECH 6

Eicher is creating a new benchmark in the Indian commercial vehicle industry, through a revolutionary BSVI solution that combines global technology with innovative support services. This solution not only makes your vehicle BSVI compliant but also ensures higher productivity of the bus and profitability of your business.



Euro VI Expertise for 6 years

VECV has been manufacturing and supplying base engines to the Volvo Group since 2013. Over 1,00,000 Euro VI base engines supplied, operating in 41 countries. First to roll out BSVI CV range in India, incorporating expertise of Euro VI technology.



Efficient EATS and engine technology

Best fluid economy: Lower fuel consumption + DEF consumption combined. Reliable EATS + engine technology tested for over 56,00,000 km. Duty cycle based SCR for high reliability & low maintenance.



Enhanced UPTIME

Eicher Uptime Centre for 24x7 support by specialists. GPS enabled service vans just a phone call away. Remote diagnostics for quick repair of BSVI vehicles.

Next-Gen Engines

The Eicher 2000 range is powered by Eicher's next-generation E366, E474 and E494 engines, which offer the dual benefits of higher power and high fuel efficiency. The flat torque curve ensures smoother drives with less gear shifts. Leveraging Eicher's Euro VI experience, these new engines are designed to be lightweight, silent, powerful and efficient.

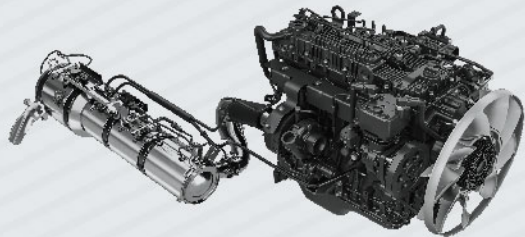

FUEL EFFICIENT E474 ENGINE: 4 CYLINDER, 4 VALVE, 3 LITRES CRS ENGINE



Introducing the all-new Eicher 2000 series high performance Eicher bus chassis. The New Eicher chassis offers best-in-class mileage and power from the advanced and reliable engines. The 2000 series chassis is suited for varied applications to ensure lifelong profitability.



Assured Reliability.

The New Eicher 2000 series chassis is designed to deliver more. Light weight and reliable Domex® chassis offers superior performance, fabrication friendly cowl design, APDA reduces moisture and oil from the air to increase the life of pneumatic system.



Engines with Proven BSVI Technology



Domex® Chassis



APDA

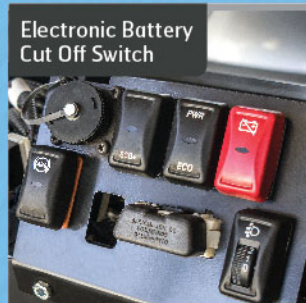

Electronic Battery Cut Off Switch



Mbooster+

Fluid Economy.

Best-in-class fuel efficiency is offered across the range through features like Fuel Coaching and Mbooster+ that enable the driver to operate in the most fuel efficient manner. Efficient engines coupled with Visctronic fan reduces the parasitic losses for better fuel efficiency; EATS ensures optimized diesel exhaust fluid (DEF) consumption.



Fuel Coaching



Visctronic Fan



Optimised Driveline

Next Gen Features.

New Three spoke easy-to-adjust Steering Wheel, New Instrument Cluster with intelligent display for better drive aids and mileage enhancing Cruise Control are some of the latest features in Eicher 2000 series. Intelligent Driver Information System keeps the driver informed of all the key parameters through an easy-to-read display and tell-tales.

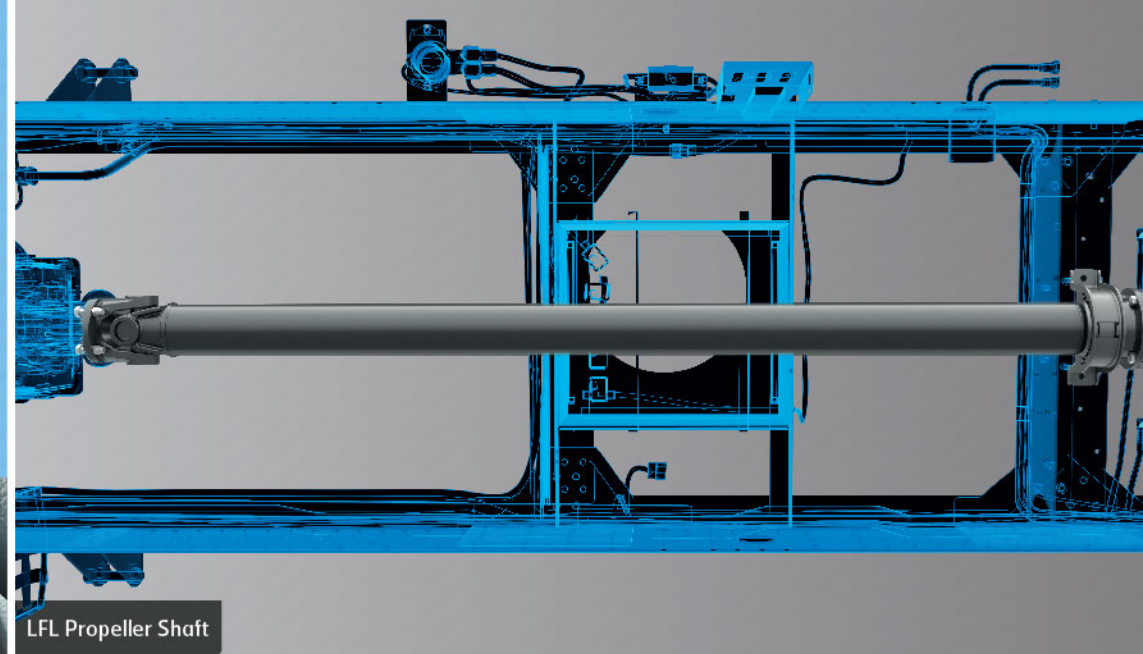
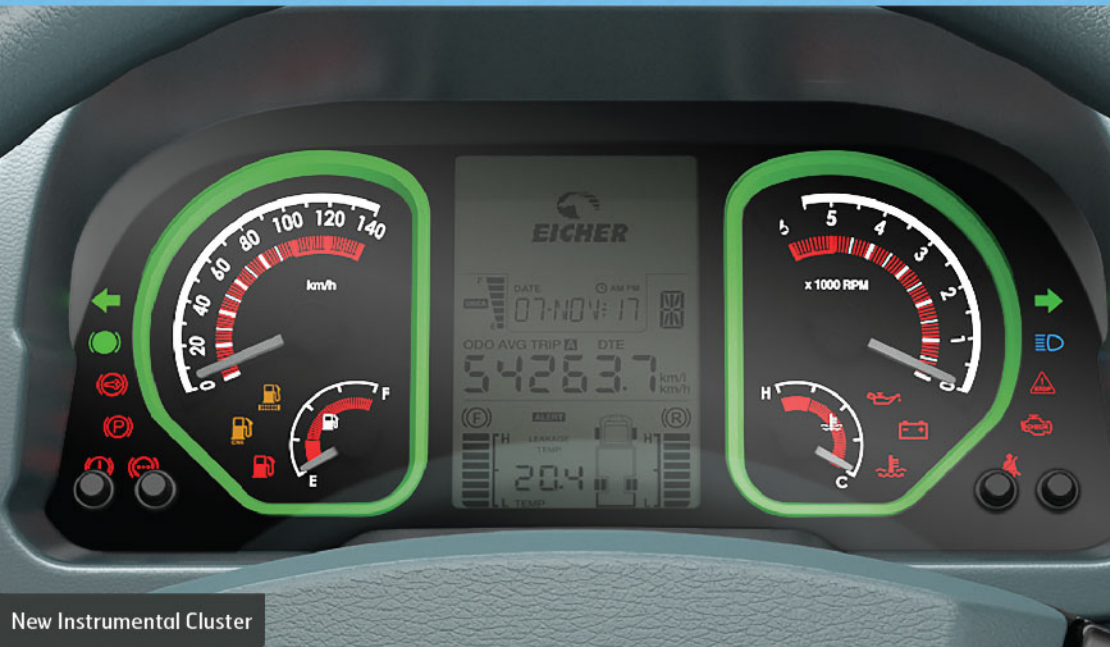

Long Lasting Durability.

Built to last is the assurance that comes exclusively in the Eicher 2000 series chassis range. A complete peace of mind through stronger aggregates Lubricated For Life Propeller Shaft and Steering, improved suspension and corrosion-free HDPE DEF tank is built in the Eicher 2000 chassis series.

Tilt, Telescopic & Collapsible Steering



Clutch Booster



Cruise Control



LFL Steering

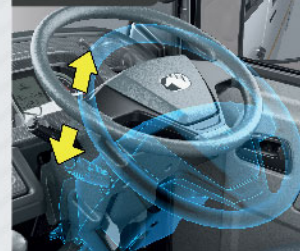

Semi Elliptical Suspension / Weveller Suspension



Clutch Wear Indicator

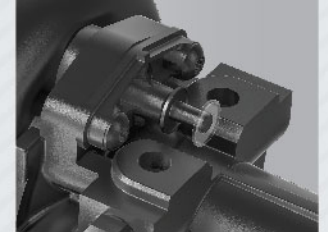

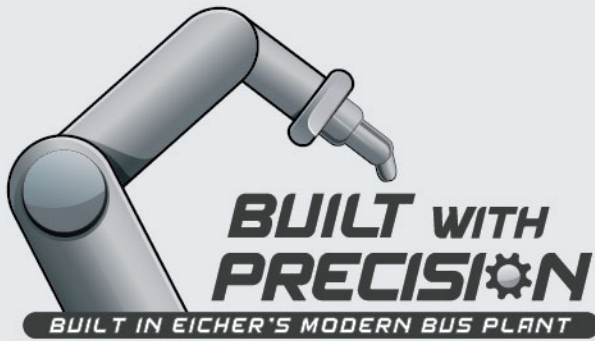

We manufacture bus chassis with high level of precision by using advanced technology like panel fitments, inverter based welding, robotic welding and pneumatic grippers in our modern Eicher Plant to deliver superior build quality.



Lifetime Support Solutions.

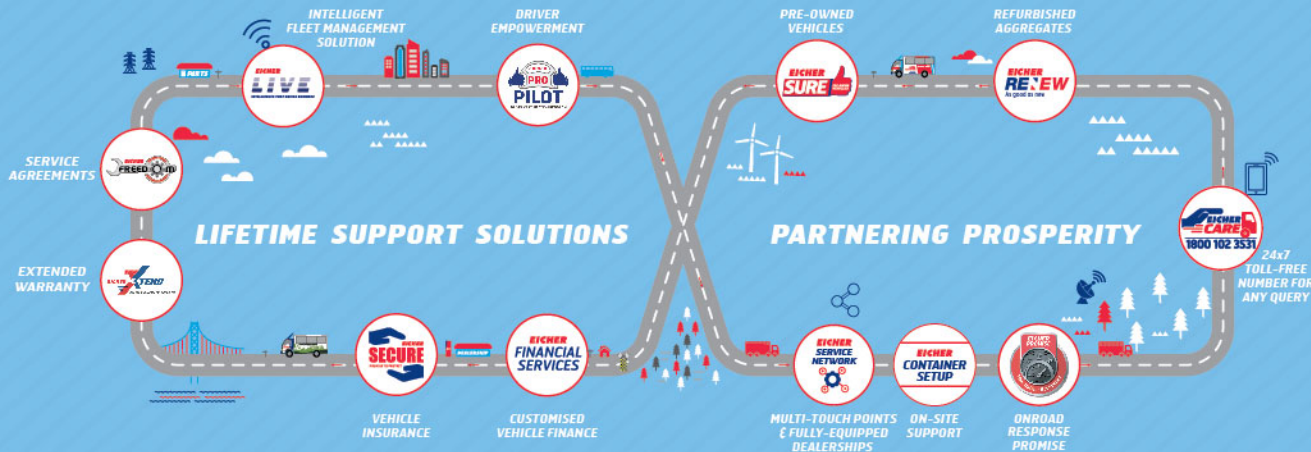

With our Lifetime Support Solutions, we ensure a seamless and hassle-free experience from the time you consider buying an Eicher vehicle to the time you think of selling it. Our continuously improving and holistic services will ensure higher uptime and productivity for your BSVI vehicles.

*Pro-Pilot, Eicher Sure and Eicher Container set-up is not available for Eicher Bus range



Eicher has taken a step towards achieving Superior Uptime with a responsive attitude, that will set us apart and create a differentiated experience for our customers. With our new Uptime Center and Uptime Certified Workshops, we are now geared up with a proactive support system for diagnostic assistance with advanced diagnostic tools.



At Uptime Certified Workshops only
*T&C Apply

Model Name	2050 C	2050 D	2070 E	2075 G	2075 H	2090 L	2112 M
Wheelbase (mm)	2850	3100	3515	3870	4320	5240	5330
Overall Length (mm)	5375	5625	6534	7089	7811	9284	9856
Overall Width (mm)	2043		1990			2413	
Overall Height (mm)	2480			2511		2785	
Ground Clearance (mm)	183		187			232	
Front Overhang (mm)	1000		1024			1370	
Rear Overhang (mm)	1525		1995	2195	2467	3020	3156
Turning Circle Diameter (m)	11.2	12.2	13.1	14.4	16	19.4	
Engine Make	E366		E474			E494	
Displacement (cc)	1999		2960			3770	
Power	100hp (75kW) @ 3200 rpm-(NAC & AC)		120hp (90kW) @ 3200rpm - NAC / 140hp(105kW) @ 3200rpm - AC			140hp (105kW) @ 3200 rpm-(NAC & AC)	160hp (120kW)@ 2600rpm-(NAC & AC)
Torque	285 Nm @ 1250- 2500 rpm-(NAC & AC)		350Nm @ 1200-2500rpm - NAC / 400Nm @ 1200-2500rpm - AC			400Nm @ 1200 - 2500 rpm-(NAC & AC)	500 Nm @ 1200-1800 rpm-(NAC & AC)
Clutch (mm)	280		310			330	
Transmission Make	ET30SS		ET35SS			ET35S6	ET40S6
Transmission Type	Synchromesh 5-Speed + 1 Rev			Synchromesh 6-Speed + 1 Rev			
GVW (Tonnes)	5.6		7.5	8.2		9.8	13.1
Chassis Type	BSK-46		Domex® 650*				
Chassis dimension (mm)	180x60x5		200x75x5			210 x 76 x 6	
Fuel Tank Capacity (L)	60		100		160		190
Brakes	Hydraulic with Disc		Dual circuit 'S' cam full air brakes				
Tyres	7.50 x 16 -16 PR			8.25x16 - 16 PR		9R20-16PR	
Suspension	Semi elliptical with ARB- Front Semi elliptical - Rear		Semi elliptical			Wevellar	
Steering	Power steering						
Battery	12V, 130Ah- (NAC & AC)					12V 130Ah-NAC 24V(2x12V) 130Ah-AC	
Alternator	110A-NAC 2x110A- AC					110A-NAC 2x120A- AC	
DEF Tank Capacity (L)	19					27	

*Available in select models



VE COMMERCIAL VEHICLES
A VOLVO GROUP AND EICHER MOTORS JOINT VENTURE
eichertrucksandbuses.com, Eicher Care: 1800 102 3531

VE COMMERCIAL VEHICLES LTD.
Registered Address – 3rd Floor Select Citywalk,
A -3 District Centre, Saket, New Delhi 110 107, India.
CIN – U74900DL2008PLC175032

CORPORATE ADDRESS
Eicher Trucks & Buses
#96, Sector – 32, Gurgaon
122001, Haryana, India.

Caution: *Do not weld or drill on chassis frame. *Accessories and features shown in pictures or elsewhere may not constitute standard fitment. *Weight mentioned is for standard configuration with standard body sizes and will change due to optional fitments. *As a result of continuous research and innovation carried out, specifications are merely indicative and are subject to change without notice.